

Power in

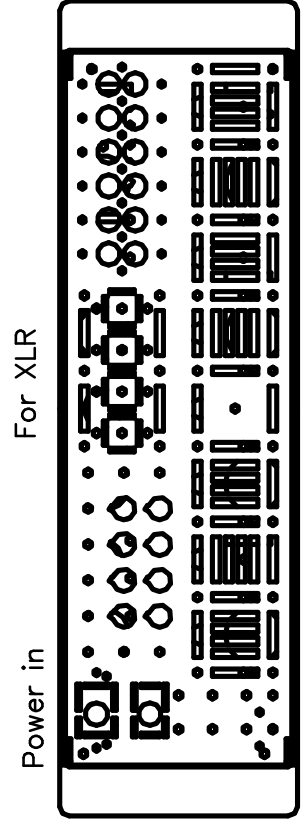

- Users may select a combination of top & bottom panels (can be used for either)
 - 432706 Slots
 - 432704 Holes (Ø5 in grid)
 - 432711 Blank
 - 432705 Valve clearance
- Rear panel may be used either way up.

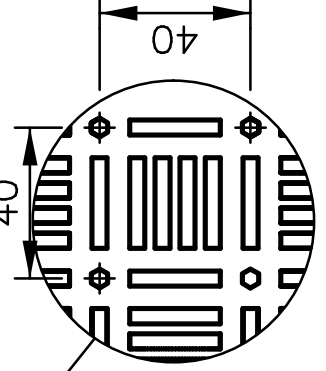
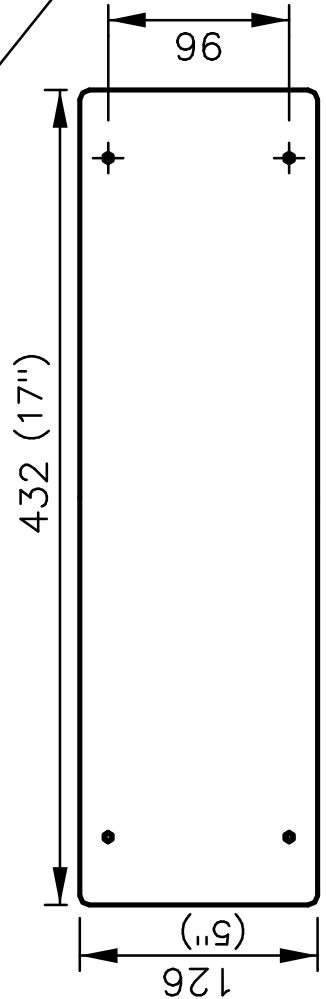
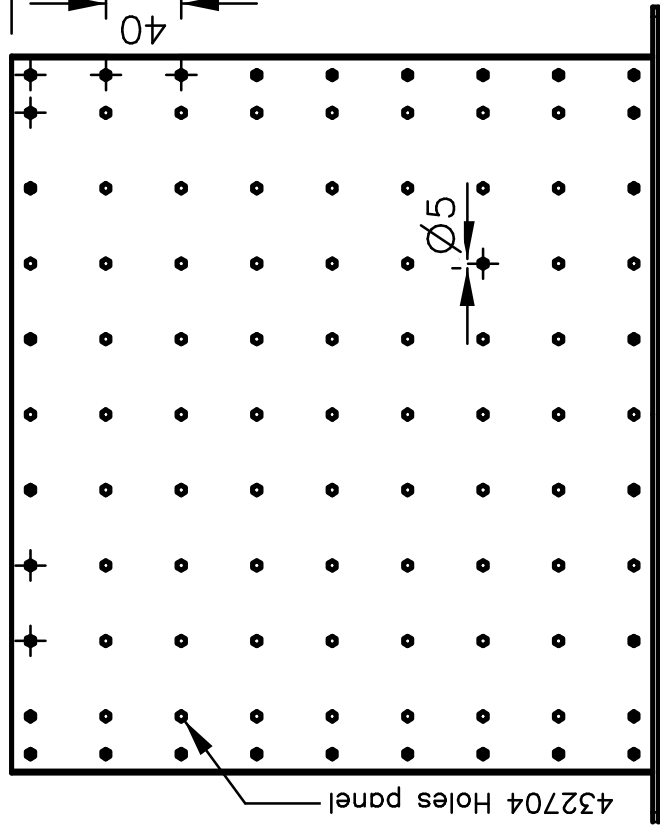
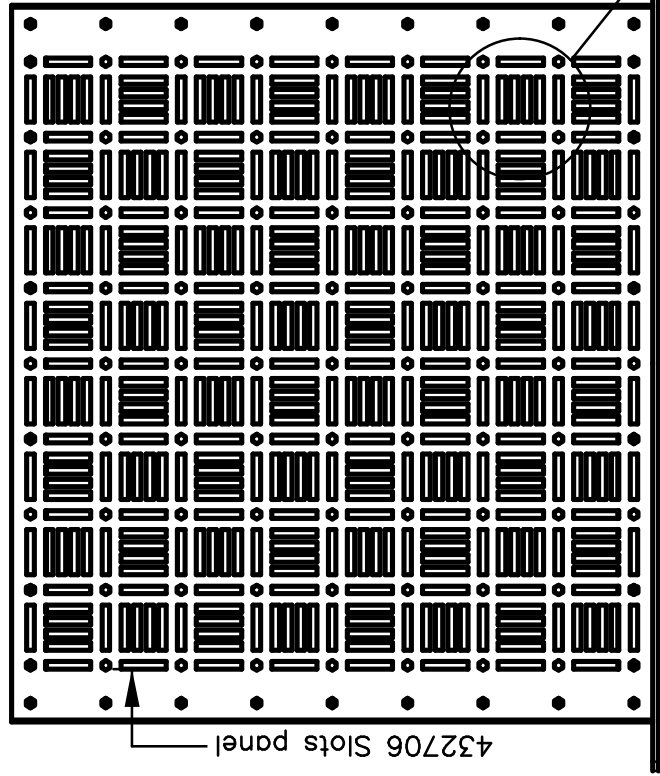
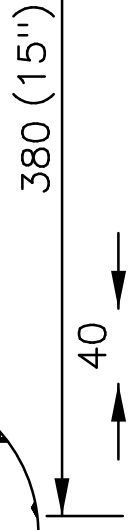
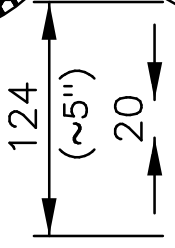
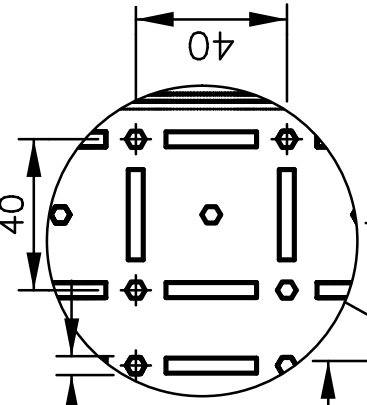

Note:
 This design is protected by Copyright and is a Registered Design.
 ezChassis is a registered TradeMark Info. correct at date of issue(20/4/08) but may be updated and improved.

www.designbuildlisten.com

